



28 Stamford Street Wendouree VIC

5 2 3

This spacious, five bedroom brick home is positioned on a corner allotment of around 587m² (approx.) in a desirable part of Wendouree. This location is popular for its proximity to an abundance of shopping outlets, the Wendouree train station, eateries and popular schooling such as Ballarat Grammar School. Inside the home you will find five spacious bedrooms, three of which have built in robes. The kitchen is open to the dining area and there is a large separate living room for the family to enjoy, while a well sized study room creates a private space for working or gaming. There are two bathrooms, the main bathroom complete with a separate spa bath and shower. There is also a full laundry. Outside you have plenty of yard space for the kids to play and dog to explore. For parking there is a single carport and additional secure off street parking. This prop...

Price : \$430,000 - \$460,000
Land Size : 587 sqm
View : <https://www.ballaratrealestate.com.au/sale/vic/ballarat-western-district/wendouree/residential/house/7933357>



Dominic Morrison
03 53312233
0409 557 461



Mitchell Burgess
03 5331 2233
0458019897

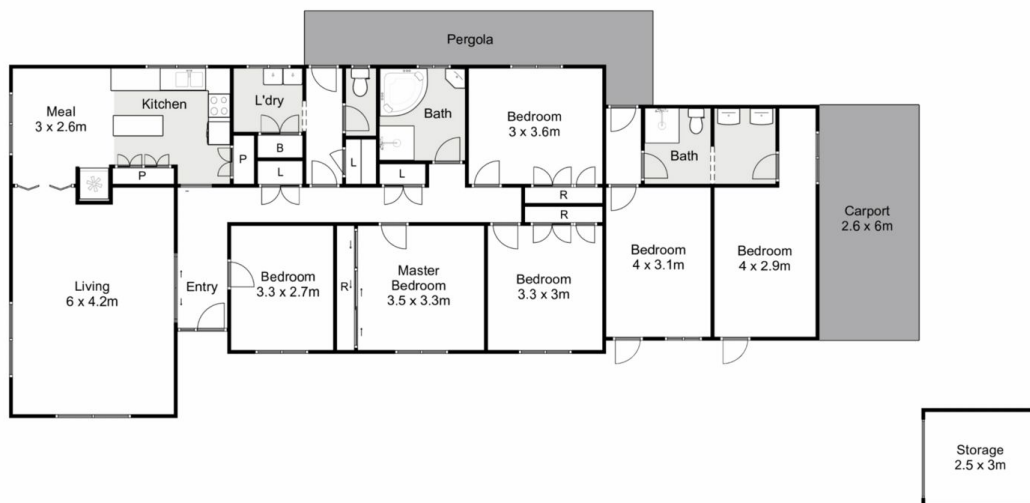

28 Stamford Street, Wendouree

Whilst every attempt has been made to ensure the accuracy of the floor plan contained here, measurements of doors, windows, rooms and any other items are approximate and no responsibility is taken for any error, omission, or mis-statement. This plan is for illustrative purposes only and should be used as such by any prospective purchaser. The services, systems and appliances shown have not been tested and no guarantee as to their operability or efficiency can be given.