

13 Lovenear Grove Ballarat East VIC

4 3 2

Nestled in the tranquility of a quiet, family-friendly locale, this impeccably constructed residence stands as a testament to superior craftsmanship and meticulous attention to detail. A grand entrance unfolds into a captivating landscape of beautifully manicured gardens, setting the tone for the charm that awaits within. Commanding an expansive allotment of over 800 sqm, the residence boasts a voluminous open-plan living and dining area, distinguished by its lofty ceilings and exposed hardwood beams, creating an inviting and spacious ambiance.

The heart of the home, the kitchen, is a haven of culinary delight with quality appliances and abundant cupboard space. This well-designed space is a harmonious blend of style and functionality, catering to the needs of both

Land Size : 802 sqm

View : <https://www.ballaratrealestate.com.au/sale/vic/ballarat-western-district/ballarat-east/residential/house/7878887>

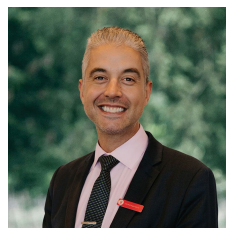

Jay Kalogerakis
03 53312233
0430200663

13 Lovenear Grove **Ballarat East**

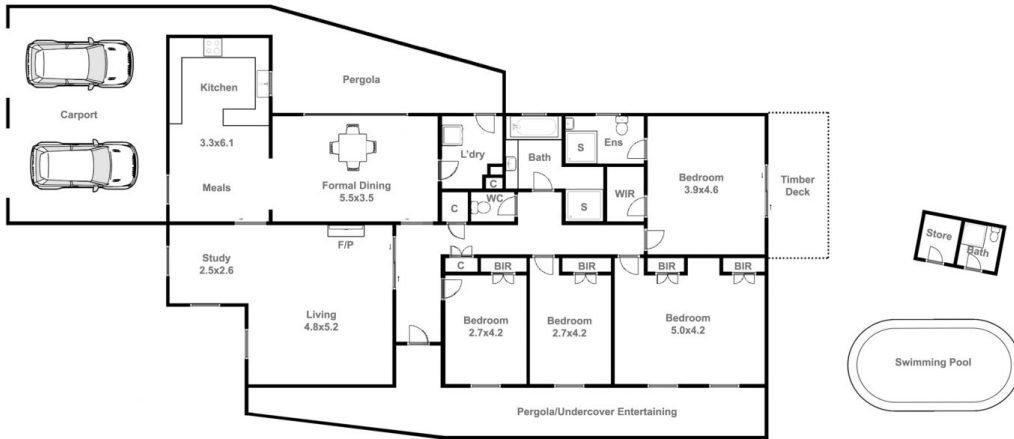

Jay Kalogerakis 0430 200 663

This plan is for illustrative purposes only, floor plan proportions and scale are approximate. Plan prepared by PLP Ballarat © 2024 for Ballarat Real Estate.