



9 Smith Street Newington VIC

3 1 2

Situated within walking distance to some of Ballarat's finest private schools, Victoria Park & Lake Wendouree is this hidden gem in a quiet street within the popular suburb of Newington. This simply stunning, tastefully updated 3 bedroom executive property is presented with style and panache both inside and out. The 3 light filled bedrooms are of a generous size with the main bedroom capturing the winter sun. The charming living room with art deco period features and timber flooring creates a warm and romantic atmosphere with a cosy open fireplace. The intimate sitting room opens onto the rear resort style deck, barbeque and Asian garden area. The kitchen includes plenty of bench space with quality appliances which is adjacent to the meals area. The bathroom consists of a large spa bath, separate shower all overlooking the rear garden courtyard. There is a E ...

Price : \$ 610,000

Land Size : 526 sqm

View : <https://www.ballaratrealestate.com.au/sale/vic/ballarat-western-district/newington/residential/house/7871844>

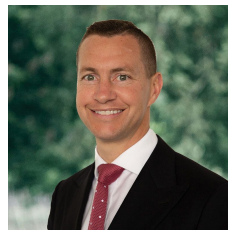

Damian Larkin
03 53312233
0417 088 755

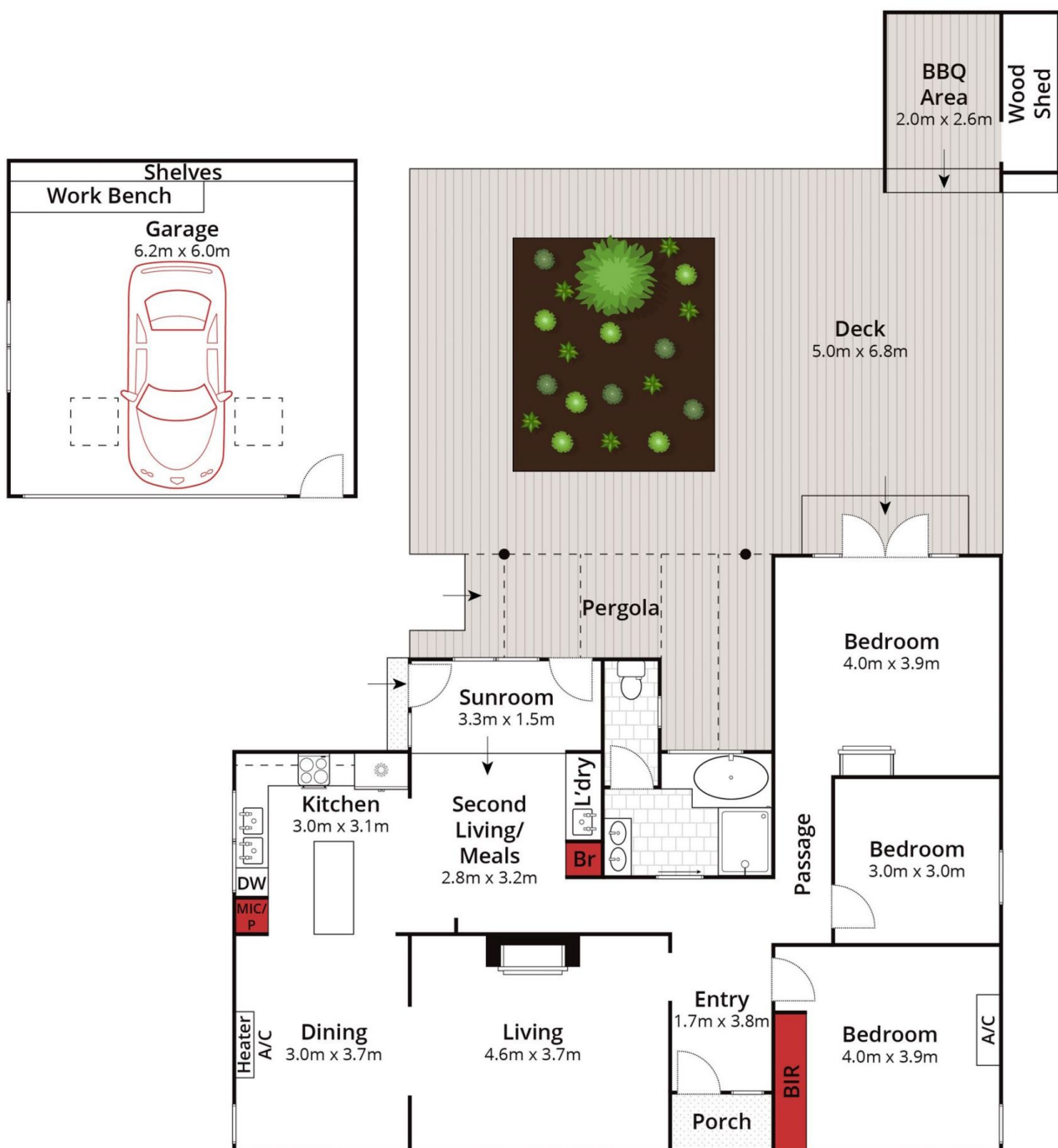

Approx House Area 120m²
Approx Land Area 526m²



Whilst bwrn.com.au has made every attempt to ensure the accuracy of the floor plan contained here, measurements are approximate and no responsibility is taken for any error, omission, or mis-statement. This plan is for illustrative purposes only.

9 Smith Street, Newington

