



**30 Elaine Avenue Alfredton VIC**

4 2 2

Ideally situated in the highly sought-after Alfredton neighborhood, this property will be of interest to those in search of a spacious family residence conveniently located near schools (within the Ballarat High School zone and within walking distance of primary schools), shopping centers, recreational facilities, and public transportation. Featuring four bedrooms, including a master suite with a walk-in closet and en-suite bathroom, two generously sized living areas, and a kitchen equipped with stainless steel appliances. The house boasts a gas central heating system, as well as a wood fire heater in the front living room to create a cozy winter ambiance. Outdoors, you'll find a covered entertainment area, a low-maintenance yard, and a double lock-up garage with rear yard access. Additional noteworthy features encompass split-system air conditioning, a spac ...

**Price** : \$ 595,000  
**Land Size** : 834 sqm  
**View** : <https://www.ballaratrealestate.com.au/sale/vic/ballarat-western-district/alfredton/residential/house/7761961>



**Damian Larkin**  
03 53312233  
0417 088 755

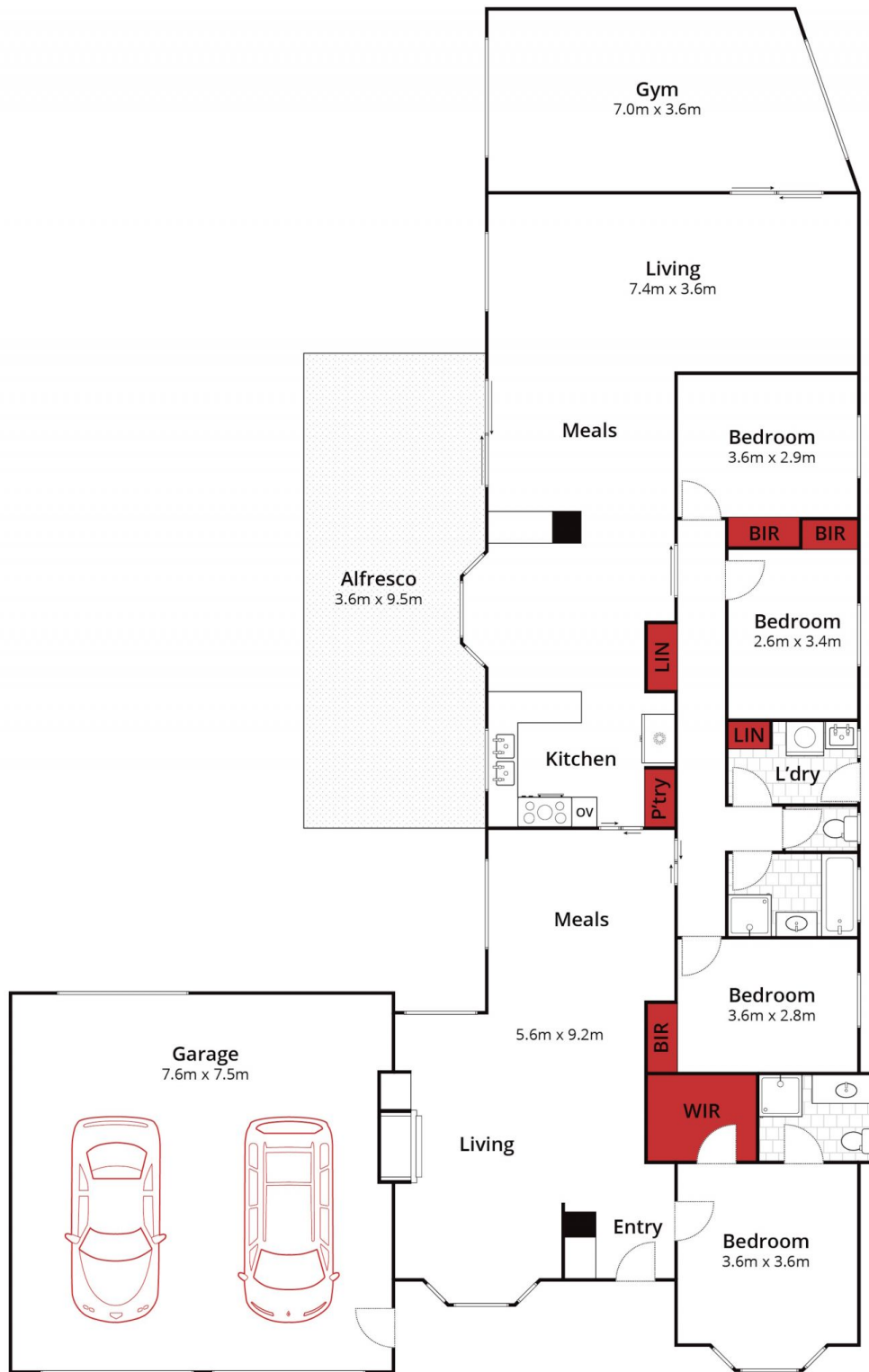

Approx House Area 206m<sup>2</sup>  
 Approx Land Area 833m<sup>2</sup>



Whilst [bwrn.com.au](http://bwrn.com.au) has made every attempt to ensure the accuracy of the floor plan contained here, measurements are approximate and no responsibility is taken for any error, omission, or mis-statement. This plan is for illustrative purposes only.

**30 Elaine Avenue, Alfredton**

