



14 Pettett Close Miners Rest VIC

4 2 2

This stunning home is in an attractive family area of Miner's rest. Close by you will find walking tracks, parks, schools, and the supermarket. Only minutes from the Melbourne freeway and located in a discrete friendly location. The home features generous land size approx. 725m2 approx.

Walking into the front door you will be greeted by the homes large long hallway. Situated at the front of the family home accommodates a study, for those who work from home. Across the hallways is a generous sized master bedroom accommodating walk in robe and ensuite. As you proceed down the hallway on your left is the first generous sized family living space, continuing down the hallways you will be stunned to find the open plan kitchen/dining space. The kitchen features a double sink, gas cooking and electric wall oven, pantry, breakfast bar, and endless

Price : \$ 650,000
Land Size : 725 sqm
View : <https://www.ballaratrealestate.com.au/sale/vic/ballarat-western-district/miners-rest/residential/house/7524994>



Alex Stepnell
03 53312233
0407373507

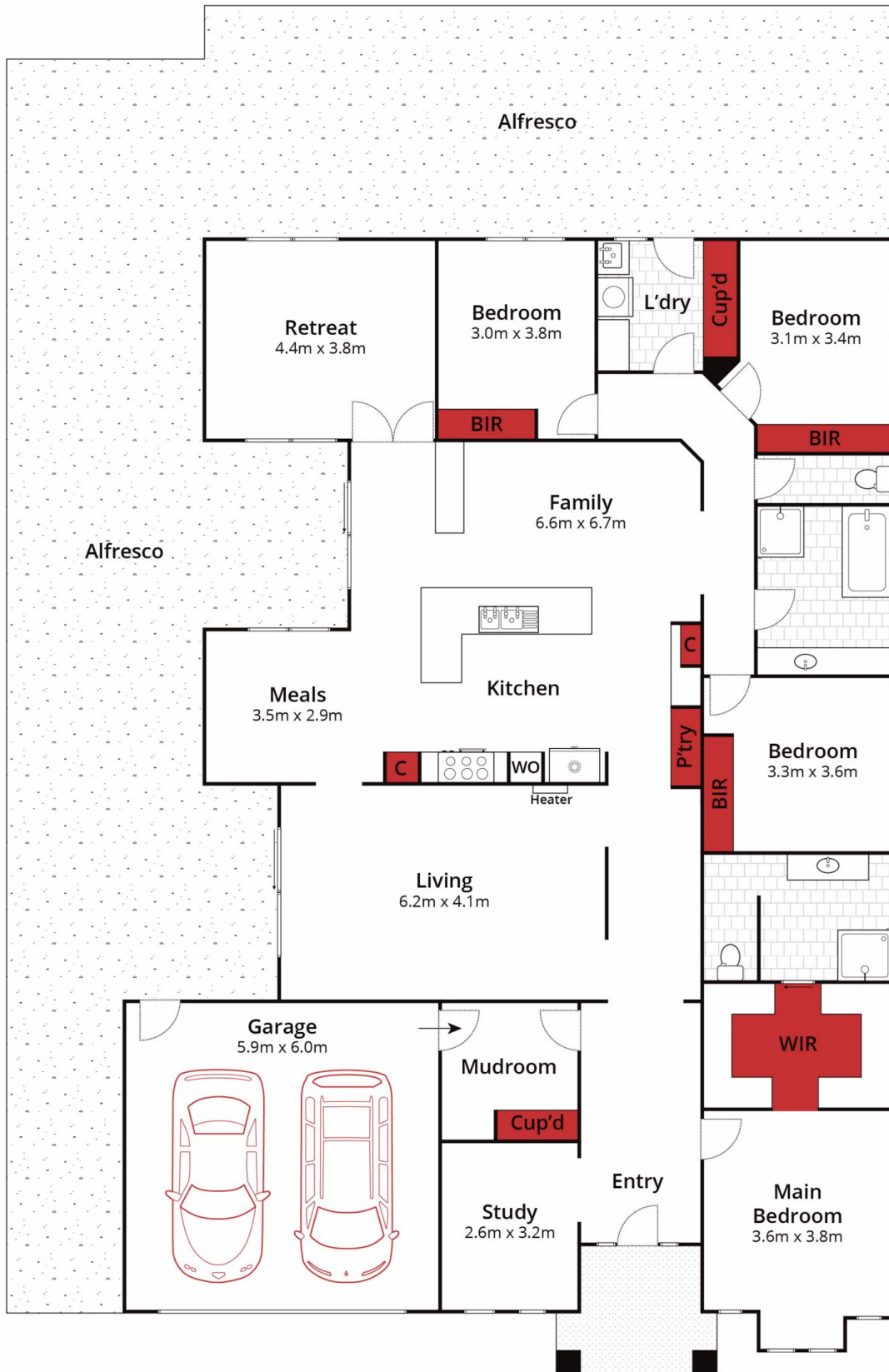

Approx House Area 264m²
 Approx Land Area 725m²



Whilst bwrn.com.au has made every attempt to ensure the accuracy of the floor plan contained here, measurements are approximate and no responsibility is taken for any error, omission, or mis-statement. This plan is for illustrative purposes only.

14 Pettett Close, Miners Rest

Ballarat
Real Estate

