



2/41 Yarrowee Street Sebastopol VIC

3 2 1

BOOK YOUR INSPECTION ONLINE 24/7 Click "Book an Inspection Time" to select a time that is suitable for you. Alternatively, go to our website [ballaratrealstate.com.au](https://www.ballaratrealstate.com.au) and press the BOOK INSPECTION button to register for a time that suits you.

View : <https://www.ballaratrealstate.com.au/lease/vic/ballarat-western-district/sebastopol/residential/townhouse/7151793>

Located in a quiet court minutes from shops, schools, supermarkets and the Geelong Highway is this low maintenance three-bedroom brick veneer home.

Entering the home, you are greeted by a formal living area which leads through to the open plan dining area and chef's kitchen which has gas and electric cooking, dishwasher and BIP. Serviced by a gas wall heater and split system air conditioning for year-round comfort. The three bedrooms are of good size and all include BIR's. The

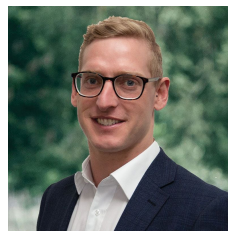

Mitchell Couch
03 53312233
0423543023

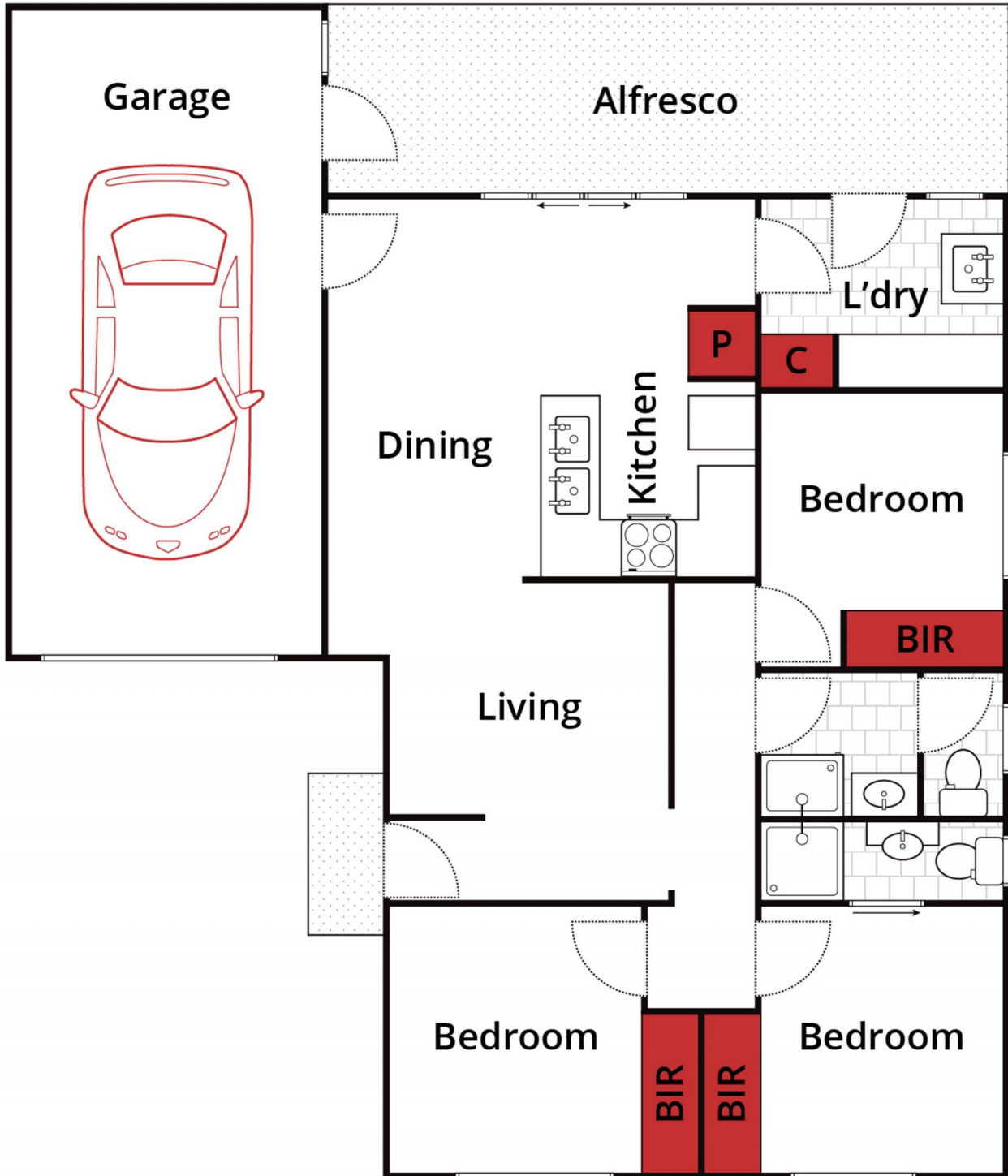

Approx House Area 90m²
 Approx Land Area 283m²

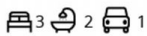

Whilst bwrn.com.au has made every attempt to ensure the accuracy of the floor plan contained here, measurements are approximate and no responsibility is taken for any error, omission, or mis-statement. This plan is for illustrative purposes only.

2/41 Yarrowee Street, Sebastopol

